

BAUSCHRITTE / MOUNTING STEPS: 1-2

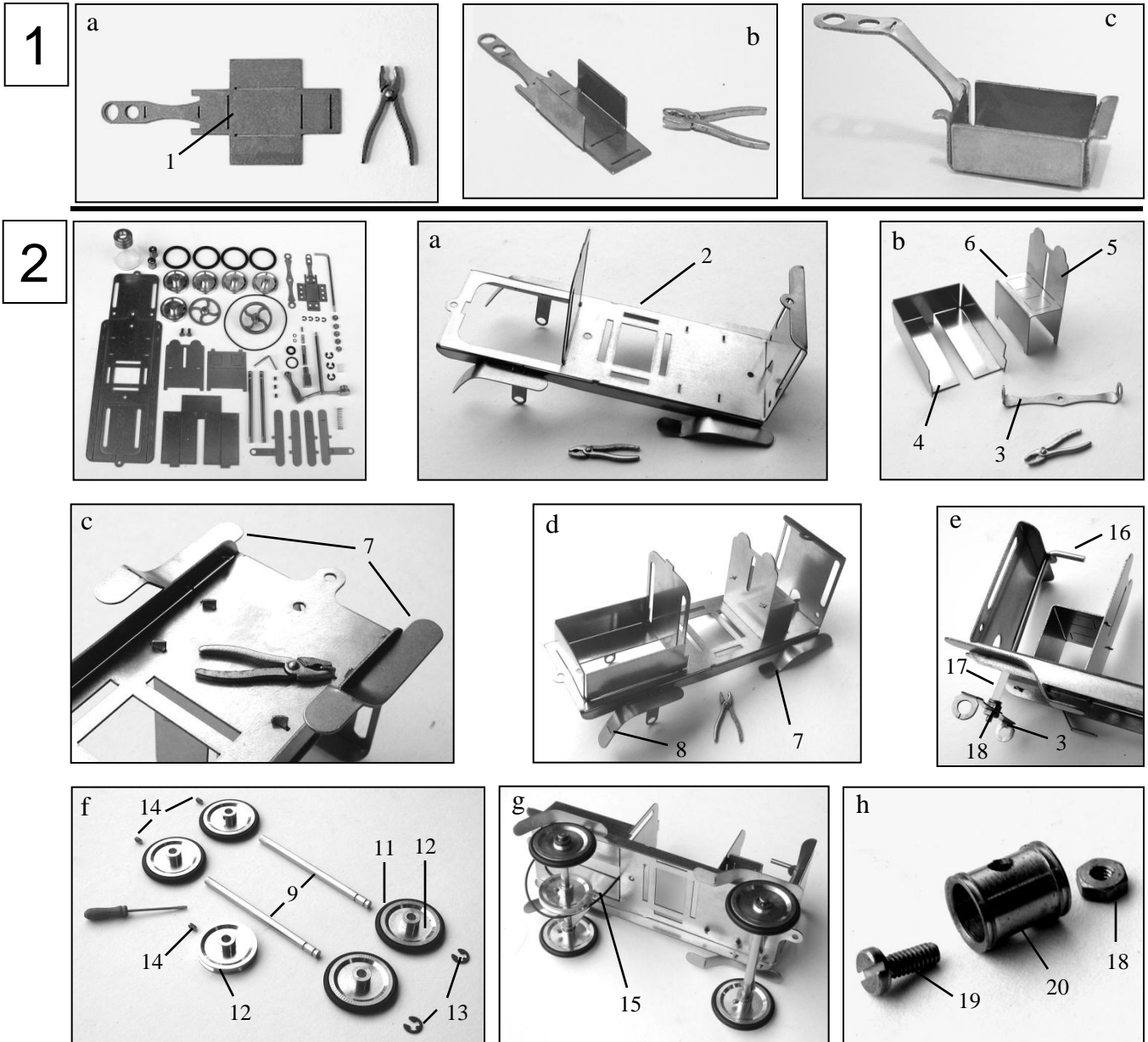

Stückliste / Part List (1)

- | | |
|---|---------------------------------------|
| 01 Brennerschublade / Fire-Drawer 1x | 18 Mutter / Nut M2 5x |
| 02 Grundplatte / Ground Plate 1x | 19 Schraube / Screw M2 2x |
| 03 Achshalter vorne / Axle-Holder-Front 1x | 20 Lampe / Lamp 2x |
| 04 Aufbau / Panel 1x | 21 Säule / Pillar 1x |
| 05 Sitzlehne back-Arm-Rest 1x | 22 O-Ring / 4x1,5 1x |
| 06 Sitz / Seat 1x | 23 O-Ring / 7x1 1x |
| 07 Kotflügel vorne / Wing-Front 2x | 24 Schwungrad / Fly-Wheel 1x |
| 08 Kotflügel + Achshalter hinten / Wing+Axle-Holder-Back 2x | 25 Antriebschlauch / Friction-Hose 1x |
| 09 Achse / Axle 2x | 26 Zapfen / Bung 1x |
| 10 Felgen / Rim 4x | 27 Kurbel / Crank 1x |
| 11 Reifen / Tyre 4x | 28 Kolben / Piston 1x |
| 12 Schnurrolle / String-Wheel 3x | 29 Zylinder / Cylinder 1x |
| 13 Klemmring / Spring-Ring 2x | 30 U-Scheibe / Distance-Ring 2x |
| 14 Madenschraube / Screws 3x | 31 Antriebsrad / Drive-Wheel 1x |
| 15 Antriebsriemen / Drive-Belt 45x1 1x | 32 Klemmring / Spring-Ring 4x |
| 16 Lenksäule / Handlebars 1x | 33 Halter / Holder 1x |
| 17 Silikonschlauch / Silikon Hub 1x | 34 Kessel / Boiler 1x |

BAUSCHRITTE / MOUNTING STEPS: 2-3

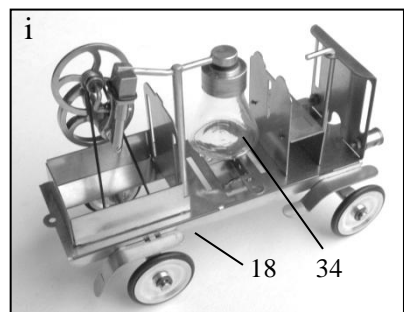
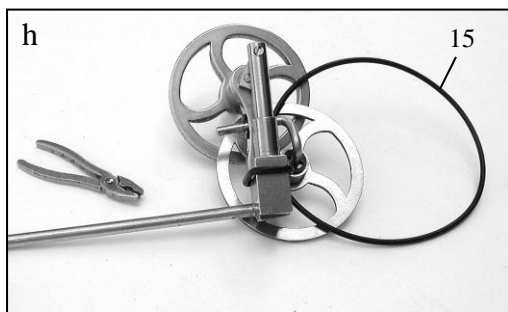
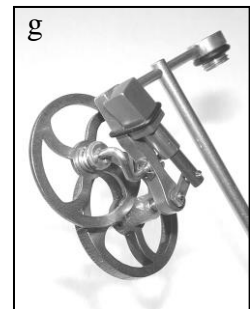
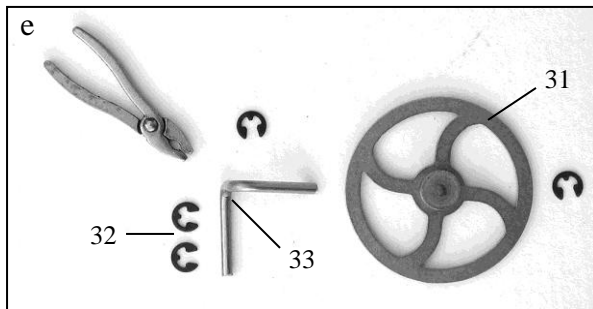
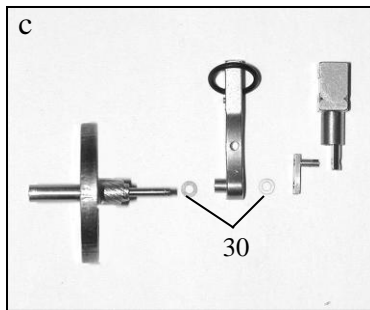
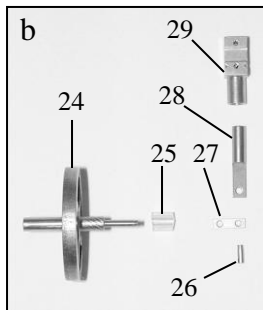
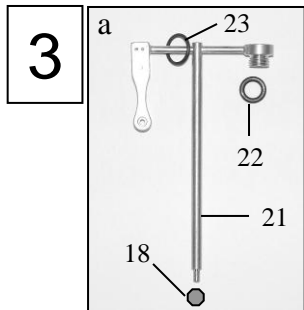
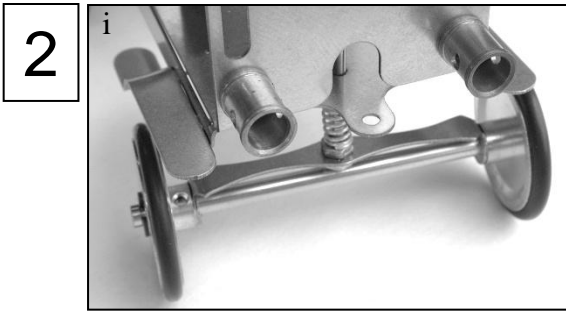

**Viel Spaß!
Have Fun!**

Änderungen welche die Funktion verbessern, können vorgenommen werden.
Small changes for better function can be do.

Lutz Hielscher
Technische Spielwaren & Dampfmaschinen
Technical Toys & Steam Engines

Schmiedestraße 52, D-42279 Wuppertal
Tel.: +49 (0)202-66 40 52
Fax: +49 (0)202-66 46 06
info@hielscher-dampfmodelle.de
www.hielscher-dampfmodelle.de

© Alle Rechte vorbehalten / All rights reserved.



Katalog (über 1.000 Artikel)
Catalogue (more than 1.000 articles)

Best.-Nr. / Order-No.: 010200